

888-674-9992



[Client Brochure](#)



## VIRTUAL FORKLIFT SIMULATORS

Designed by trainers for trainers, this new generation forklift simulator is built to help industry trainers support the OSHA training guidelines.

Tools not Toys is how we see the next generation of forklift simulator, real world training tasks, custom developed environments all at designed to maximize your training ROI.

Virtual Forklift offers two very different forklift simulator training systems:

- Virtual Forklift NEXUS is the traditional forklift simulator with modules and VERY REALISTIC environments.
- Virtual Forklift LIVE is the ONLY multi-student Forklift Simulator that allows for instructor interaction with the students and drivers LIVE.



## VIRTUAL FORKLIFT NEXUS MODULES AND OPTIONS

The best software or training system in the world is worthless if the cost is prohibitive. The module design and delivery of the Virtual Forklift NEXUS Simulator software, allows for lower cost entry and growth as a budget or need increases. Bundles help users decide on the most important modules to their business and they can select the training type and features that fit their training needs. Pay per use options allow clients to use a module or group of modules during a hiring push and remove them when the need is no longer there, similar to a rental option. Modules are divided into 3 categories, standard, advanced, and custom.

### SIMPLE MENU FOR MODULE SELECTION

Students can select the training module from our easy to read and simple to understand training menu. Additional advanced modules and custom training environments can be added as your training needs change or expand.



Advanced modules are designed to teach loading of box trailers and flatbed trailers, as well as the use of specific attachments, special load handling or difficult tasks. Initial attachment options will include the use of a flat box clamp, single/double forks, carpet poles, fork extensions and the safe use of a trash hopper, others will be created regularly to keep training options fresh and targeted.



Custom environments can be created using a customer's real facility and special load styles that will be developed around the customer specific rules and needs. Custom development is done on a time and materials basis.

Unique to the Virtual Forklift NEXUS Simulator is the full use of all modules for the initial 30 days; this will allow your organization to try the modules and select the ones that best fit your organization.

Custom environments will be available to all simulators at the facility and will only be billed at an advanced module price for additional simulators. The ROI of custom development is maximized since it is available to all site simulators.

Module purchases are like purchasing options on your vehicle, if you do not want an option or module, why pay for them.

Modular purchasing also allows you to get into Virtual Forklift training well under industry standard costs. Different business models may only need the standard modules where others will want them all, the flexibility in modular training and modular sales is one of the unique and powerful tools available with the NEXUS System.



### BUNDLES FOR SIMPLIFIED COSTING

To simplify the ordering process, we have also designed "bundles" that provide you with a pre-set number of modules at a flat price, but you pick the module making entry and use easy as SMALL, MEDIUM and LARGE!

Bundle Options (software only, hardware platform selected separately, prices USD)

<u>SMALL</u>	<u>MEDIUM</u>	<u>LARGE</u>
MSRP: \$5000.00	MSRP: \$10,000.00	MSRP: \$15,000.00
- 1 advanced module	- 2 advanced modules	- All Environments
- All standard modules	- All standard modules	- All Modules

### PEDESTRIANS CAN BE TURNED ON OR OFF

Pedestrians are an option in this training system, but they are available when interaction with them is important. The pedestrian system is designed to not only have pedestrians, but for them to react to the operator. Pedestrians will stop, and move out of the operator's way when the horn is used.



### SIMPLE AND QUICK LOGIN

Students can be pre-setup, so login is as simple as selecting their email and entering in a 4-digit code. For non-registered students, a guest login allows for quick access to training modules.

### FREEROAMING MODULE

Not only does the NEXUS system come with many pre-developed modules designed to teach specific skills or reinforce specific habits, there is a Free Roaming option that lets the student perform any task in any environment that the trainer has access to. This means instructors can create their own training tasks for students and help them to work on specific skills or train on operations that we may not have thought of yet.



### STUDENT GUIDANCE



Every training module is designed to help the student to move through the tasks with simple arrows and color coding. Green boxes show the student where to drop the load, and arrows set the path to be traveled in the module. Once completed, students will see a congratulations screen showing they have successfully completed the training. In addition to visual guidance, the NEXUS system also comes with AUDIO Guidance, to remind the student when they perform an unsafe action.

### REAL WORLD SITUATIONS

Speed doors. Poles, and blind corners are part of everyday live for forklift operators. With the NEXUS system, these types of scenarios are built into the existing modules. For an operator to complete a task, they must not only watch out for pedestrians but travel through speed doors, or maneuver past poles that restrict load size. These types of situations are why we say that the Virtual Forklift NEXUS simulator is built by trainers for trainers.

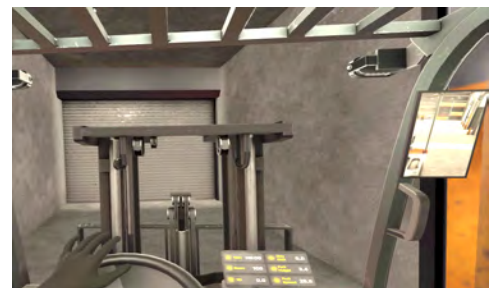

## **DRILLS FOR EFFECTIVE SKILL TRAINING**



When building the proper skills, drill-based learning is very effective. The NEXUS system utilizes standard drills typically used by trainers to teach the necessary driving procedures. Figure 8's, 90 degree turns, cones, pallets, and barrels maneuverability help students to learn to drive quickly and efficiently.

Some of the drills for driving include:

- Figure 8
- 90-degree turning
- 90-degree slalom



## **ADVANCED MODULES**

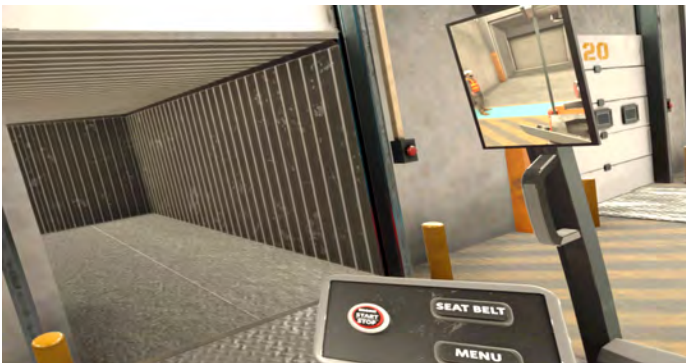

General driving, drills and hazards help develop the basic skills an operator needs to use a forklift, however, there are many different advanced skills they must learn to perform their jobs on a day-to-day basis. Not all organizations need this training (why we sell modular) but the options are there for those that require some more advanced training options. These include training on loading trailers, flatbeds, working with cantilever racking and various attachments.

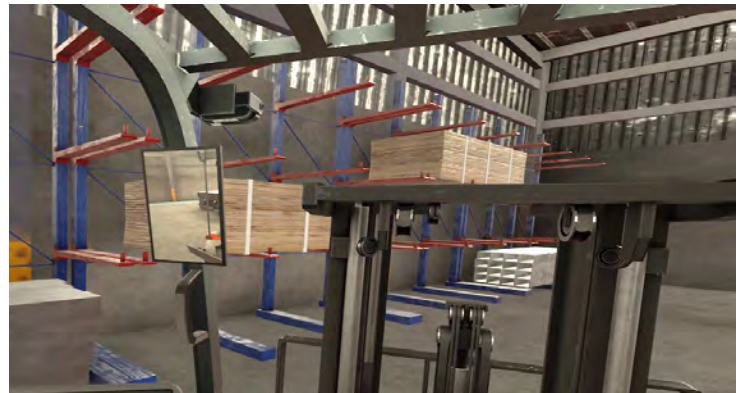

## **CUSTOM MODULES AND ENVIRONMENTS**

Customers that want to replicate their exact facility or build a training module around a specific task have the option to work with us directly. Your Virtual Forklift Dealer can work directly with the team from Virtual Forklift to recreate any environment or training module that fits your specific company needs. While these custom projects are billed separately and can take from 30 to 120 days to create, the advantages are endless. So if your organization has a special project, know we can build it for much less than you may expect.



## VIRTUAL SIMULATOR TRAINING PORTAL

Included with every simulator is access to the Virtual Forklift Trainers portal, [www.MyVirtualForklift.com](http://www.MyVirtualForklift.com). This is where all the training records for every student are recorded.

Each institution instructor can setup their students in advance of their training session providing companies with the ability to track and control the training sessions of their operators. For companies that just need a quick training session, a GUEST user can be used.

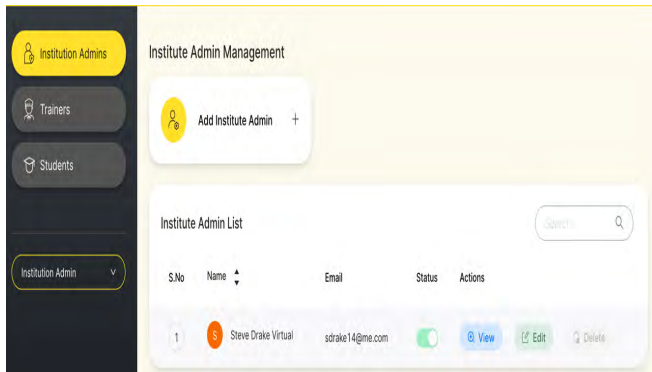
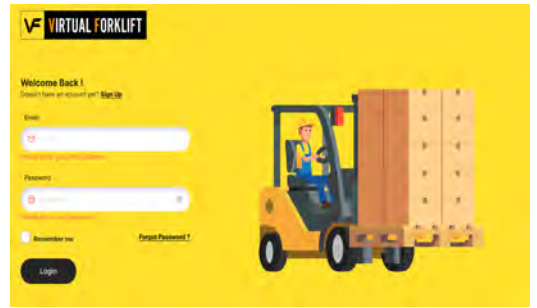

Company administrators have access to all training records and can setup company trainers to monitor and manage the training of the Virtual Forklift Students.

Company Trainers can setup and view the Virtual Forklift Driving records of their students. The system tracks all scores for each module and requires a student to complete each module safely

to pass. Immediate fail records are generated for accidents, or a combination of errors that reduces the 100% score to below the 70% threshold. The system tracks many different safe driving issues like traveling with a load to high, not looking when traveling in reverse, hitting a pedestrian, and many more common safe driving issues.

While training the records for each student and each module session help support the OSHA 1910.178 guideline for formal training requirement, every system session is also recorded in video.

Score		
83	Guest	83 Score
100	Guest	100 Score
100	Guest	100 Score
94	Guest	94 Score

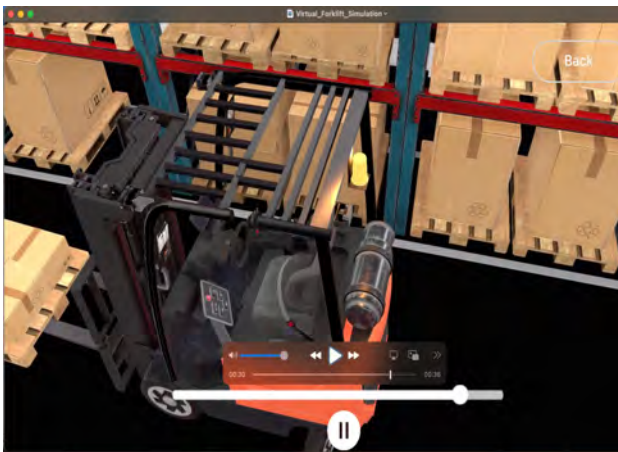
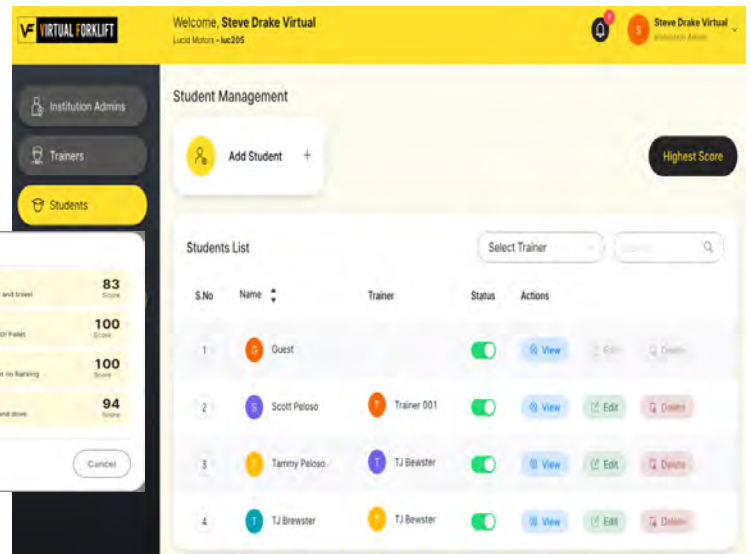

Trainers can review the driving session of every student including the Guest operators. The video replay provides a 4-camera moving view of all driving sessions for every student.

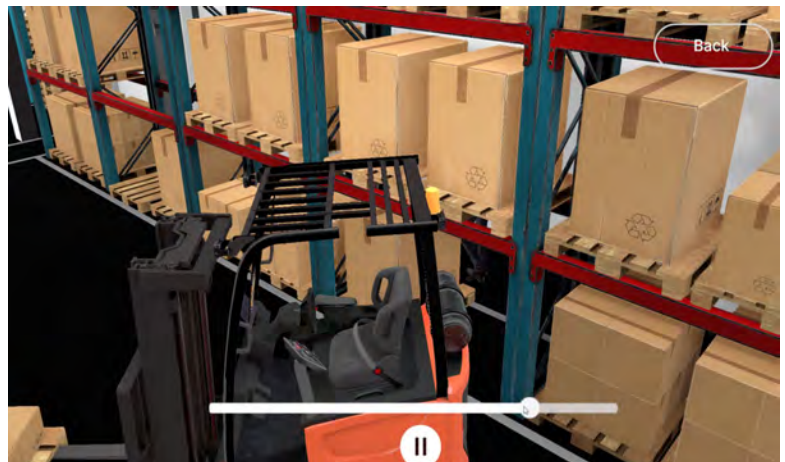



# VIRTUAL FORKLIFT LIVE

The NEW and most interactive Virtual Forklift Simulator option has arrived!

Virtual Forklift Live is an interactive “multi-user” training tool, designed to allow real time forklift operator training and driving evaluations in a virtual warehouse. The system is built to work with the Oculus Pro 2 VR headset and combined with a proprietary environment, allow trainers to teach forklift safety and evaluate operator driving in live action from anywhere to anywhere in the world all at the same time.

The system is built with 3 interactive options, Trainer, Student and Driver.

**Trainers:** This system level provides a qualified trainer to present forklift safety training materials, slides and videos in the same manner a live instructor would in a classroom setting.

- Training materials can be purchased from your local Virtual Forklift Dealer and uploaded to the training system or trainers can upload their own training materials to review with their students.
- Testing can be done online with test results saved in the VirtualForkliftLive.com system, for grading and review. This section will satisfy the OSHA formal training standard of the 1910.178 standard. Other country training materials can be uploaded for compliance.
- Trainers can also interactively watch operators drive a forklift in the virtual environment, request them to perform driving tasks including moving pallets in a standard rack system. While this may or may not satisfy the hands-on evaluation part of the requirement, it can provide substantial training and interactive real time instruction between the trainer and the student. In some cases, additional real-world hands-on training may be required.

**Student:** A student can watch the training presentation, ask questions, and interact with the instructor in real time. Testing can be completed online, and students have a fully immersive training experience.

**Driving Platform:** If the facility has the driving platform on site, any student in the proximity of the platform on the same WIFI can perform the requested driving tasks.

**Software Costing:** This product is sold as a service, which allows for lower entry cost and standard monthly or annual fees. The charges are NOT per user, but per headset, so multiple students can use a single headset in the organization. A typical configuration is 1 trainer, 4 students and 1 platform totaling \$500 per month, software only.

- Each Trainer = \$200 per month or \$2400 per year
- Each Student = \$50 per month or per headset \$600 per year
- Each Driving Platform = \$100 per month or \$1200 per year for the software that allows the location to perform interactive driving. (Requires platform purchase see below)

To initiate a training session, the instructor assigns students to a class then to a session. There is a set day and time for everyone to meet. Once all students have joined, the instructor can conduct a standard forklift safety class using their own materials or purchase a training package from your local Virtual Forklift Dealer. The training materials exceed OSHA standards but are ONLY for sit-down counterbalanced forklifts.

Note: The Virtual Forklift Live system currently has the ability to work with VR controls from select other vendors, contact us to evaluate your controls. Custom modifications are available, allowing Virtual Forklift LIVE to maximize your current investment.

*\*Additional usage costs may be necessary for high volume customers.*



Users



User Roles



Class



Session



Presentation



Recordings



Email Settings



Agora Settings





Unlike our NEXUS product or other forklift simulators on the market today, this is a truly interactive and engaging training tool, offering forklift instructors to be *in the training* environment engaging the students directly and in real time.



Built to be affordable and provide real instructor training, the Virtual Forklift Live system is a multi-student environment and designed to be very similar to the classroom and hands on evaluation situations that forklift instructors are involved in every day. Students can view a training PowerPoint, watch safety videos, and interact from the instructor's presentation. The instructor can speak, interact, and answer real time questions just like a standard forklift operator training class. When class is completed, students can drive in their local simulator, and the instructor can observe, and evaluation the driving skills of any or all students in real time.

There is currently no limit on the number of students that can be in the class, the only requirement is that you have one of our driving platforms, an Oculus Quest 2 head set and access to the environment.

There are no location or distance limitations, to this system! The instructor can be in a corporate office in Wisconsin, and the students can be in multiple locations around the country or around the world and everyone can participate in live time.



Since this system is built to be a "Certification and Evaluation" training class, the cost of the hardware is considerably lower than our NEXUS system or any other forklift simulator on the market today. Typical hardware platform costs are \$5,500 for the platform and the entry level VR Training software monthly costs start at \$500.00 per month. This hardware price includes 5 Oculus headsets, the Fold n Go mobile platform, a basic laptop computer and our exclusive forklift controller.

The training environment is sold as a service, and includes access for 1 trainer, 4 students and 1 driving platform, and for companies with multiple locations there is NO ADDITIOANL cost for locations, the only limit is hardware! Just add another Fold n Go platform and an additional site can be online in minutes.

The platform can be the Fold n Go or any of our other platforms, and instead of using the HTC Vive Pro2 headset, we use the standard Oculus Pro2.

The training is recorded in our Live portal and students will have their lessons and classwork recorded for the instructor or HR to access at any time.

To see a video demonstration of the new interactivity of the Virtual Forklift Live, please go to: [VirtualForklift.com](https://VirtualForklift.com) and watch the video on the Live VR Trainer page, it will amaze you!



## VIRTUAL FORKLIFT PLATFORM OPTIONS



### MULTIPLE OPTIONS FOR SIMULATOR PLATFORMS

The power and flexibility of the Virtual Forklift Simulator system starts with state-of-the-art software development. How each customer deploys the system can be different depending on the training needs and available training area. Companies may choose to use a “Fold n Go” Traveling platform, providing the most flexibility in where the training is done. While schools and companies with training centers may choose one of the Classroom platforms. The basic classroom provides an actual forklift seat, controls, and a stable sitting environment, while the Replica version has a real forklift look and includes a haptic seat interaction allowing the driver to feel the motion of the lift movements of the lift.

Platforms do not define the system however, either option allows for the full operation of any training module.

### BEST IN CLASS VIRTUAL REALITY HEADSET AND GAMING COMPUTERS

The NEXUS system uses the HTC VIVE Pro 2 system which provides the best visual resolution possible, combined with high-speed gaming computers, faster memory and the top-of-the-line NVIDIA 4080 video card, motion sickness users experience in other systems is greatly reduced and eliminated in many cases. Every NEXUS simulator system comes with these high-speed options, pre-configured the best user experience possible.



Customers that select the LIVE simulator training system, utilize the Oculus Pro 2 headset. This wireless option does not have the resolution of the HTC but still provides high quality simulation with the freedom of movement and multiple student interactions.

Also included with every system is our industry standard fingertip controller. Many new lifts utilize this ergonomic style lift controller, and the Virtual Forklift Simulator emulates this future lift controller style.



### “FOLD N GO” TRAVELING SIMULATOR PLATFORM

The Traveling Simulator Platforms provides the most flexible and cost-effective way to deploy the training program. A standard gaming stand, steering and 3 pedal system provides the easiest way to setup and use the system in different locations. The Fold n Go makes setup and deployment a snap! In about 10 minutes you can have your students up and running, just unfold the stand and plug in the laptop and you are ready to go. The Fold n Go case is very sturdy and can be shipped or put in the truck of your car for easy transport from each training location. This platform is great for companies that want to use the simulator and then put it away for another day.



### CLASSROOM SIMULATOR PLATFORMS (BASIC OR REPLICA)



For those that want a more stationary system, Virtual Forklift Simulator provides two (2) immersive simulator platform options for both the LIVE and the NEXUS systems. The Classroom platforms include a standard forklift seat and a solid foundation for the controls and student comfort.

The Basic Classroom is a standard system without the look of a forklift, but it is compact, comes with wheels and will fit in any standard doorway. While the Replica option provides a proper forklift structure that has an overhead guard in a standard forklift look as well as motion control built into the seat. This platform will also fit through any standard doorway and rolls easily for classroom setup.



*(Replica platform shipping in 2<sup>nd</sup> quarter 2024)*



### PLATFORM PRICING

Virtual Forklift has separated the price of the hardware platform from the software systems, this allows the customer to decide on the type of training environment they wish to deploy. There are some basic similarities between the NEXUS and the LIVE system, but overall platform costs vary greatly.

#### NEXUS Platforms:

All NEXUS platforms come standard with the following hardware:

- Logitech steering and 3 pedal system.
  - Alienware Gaming Laptop with the NVIDIA 4080 graphics card
  - Virtual Forklift controller
  - 1 HTC Vive Pro 2 VR headset with Leap Motion
- 
- Fold n Go: \$ 9,500.00
    - This is a portable option allowing for 10-minute setup and virtual training anywhere there is power. The system comes with a solidly built travel case and a built-in folding driving stand.
  - Classroom Basic: \$ 9,500.00
    - This is a basic system designed to provide a solidly constructed driving feel by using a standard forklift seat and built in controls.
  - Classroom Replica: \$22,500.00
    - Built to provide the most immersive training environment possible, this system replicated the look of a real forklift, and the forklift seat is built into a haptic environment that provides the student with the motion and feel of a real forklift.

#### LIVE Platforms:

All Live platforms come standard with the following hardware:

- Logitech steering and 3 pedal system.
  - Basic I5 Laptop (no special video controller required)
  - Virtual Forklift controller
  - 5 Oculus Pro 2 Headsets (additional headsets require additional software licenses)
- 
- Fold n Go: \$ 5,500.00
    - This is a portable option allowing for 10-minute setup and virtual training anywhere there is power. The system comes with a solidly built travel case and a built-in folding driving stand.
  - Classroom Basic: \$ 5,500.00
    - This is a basic system designed to provide a solidly constructed driving feel by using a standard forklift seat and built in controls.
  - Classroom Replica: \$ 18,500.00
    - Built to provide the most immersive training environment possible, this system replicated the look of a real forklift, and the forklift seat is built into a haptic environment that provides the student with the motion and feel of a real forklift.

*\*Prices subject to change, listed price based on current hardware costs.*

*\*Dealers or customers can purchase their own hardware, except for the forklift controller, full specs available upon request.*

## PRICING AND QUOTE



### Select training system:

#### NEXUS:

##### Bundle Options:

- ☐ SMALL = \$ 5,000 includes all standard drills
- ☐ MEDIUM = \$ 10,000 includes all standard drills and 1 advanced module
- ☐ LARGE = \$ 15,000 includes all standard drills and all advanced drills

#### LIVE:

##### Bundle Options:

- ☐ Entry Level = \$ 500.00 per month **(Includes: 1 Trainer | 4 Students | 1 Driver)**

##### Additional training options:

- ☐ Trainers qty: \_\_\_\_\_ @ \$ 200.00 ea per month
- ☐ Students qty: \_\_\_\_\_ @ \$ 200.00 ea per month
- ☐ Driver's qty: \_\_\_\_\_ @ \$ 200.00 ea per month

**Section Sub Total:** \$ \_\_\_\_\_

### Select platform:

#### NEXUS:

- ☐ Fold n Go qty: \_\_\_\_\_ @ \$ 9,500.00 (1 HTC Vive Pro 2 Headset)
- ☐ Classroom Basic: \_\_\_\_\_ @ \$ 9,500.00 (1 HTC Vive Pro 2 Headset)
- ☐ Classroom Replica: \_\_\_\_\_ @ \$ 22,500.00 (1 HTC Vive Pro 2 Headset)

#### LIVE:

- ☐ Fold n Go qty: \_\_\_\_\_ @ \$ 5,500.00 (5 Oculus Pro 2 Headsets)
- ☐ Classroom Basic: \_\_\_\_\_ @ \$ 5,500.00 (5 Oculus Pro 2 Headsets)
- ☐ Classroom Replica: \_\_\_\_\_ @ \$ 18,500.00 (5 Oculus Pro 2 Headsets)

**Section Sub Total:** \$ \_\_\_\_\_

### Select Training Options:

- ☐ On Site: 1 day setup and training: @ \$ 3,000.00 + Travel Expenses
- ☐ Online: 4 hours system review: @ \$ 500.00

**Section Sub Total:** \$ \_\_\_\_\_

### Select Materials Options:

- ☐ Train the Trainer Course & Materials  
\$ 1,600.00 per person: qty \_\_\_\_\_ Total = \$ \_\_\_\_\_
- ☐ Training Materials ONLY  
\$ 800.00 per company: qty \_\_\_\_\_ Total = \$ \_\_\_\_\_

**Section Sub Total:** \$ \_\_\_\_\_

Company Name: \_\_\_\_\_

PO# \_\_\_\_\_ Date: \_\_\_\_\_

Contact Name: \_\_\_\_\_

Approval Signature: \_\_\_\_\_

Contact Email: \_\_\_\_\_ Phone: \_\_\_\_\_

**Quote Total:** \$ \_\_\_\_\_

*Freight, Tax additional  
Quote valid for 30 days.*